



Holt Hill, Beoley, Redditch B98 9AT

£469,950

1 1 2



The Cottage is a unique and characteristic one/two bedroom semi detached 17th century period property, refurbished by the current owners to a particularly high standard and offered with a grand entrance hall in use as a dining area, a spacious dual aspect lounge with feature brick built fire place, traditional style galley kitchen, master bedroom with modern bathroom, manicured gardens, off road parking and detached double garage with planning permission for change of use to living space, Planning Reference; 22/01515/FUL . Situated in the sought after village location of Beoley.





The Cottage, Beoley

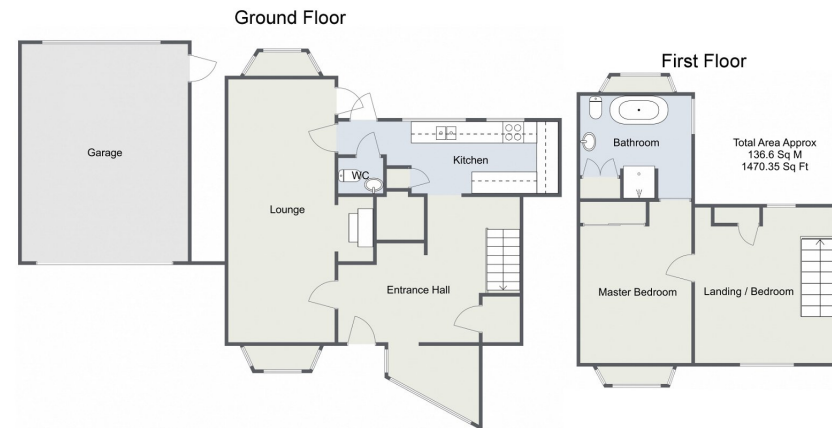

For illustrative purposes only. Decorative finishes, fixtures & fittings do not represent the current state of the property. Measurements are approximate & not to scale. Floor Plans made using RoomSketcher.



For more information on this house or to arrange a viewing please call the office on:

01527 540 654

Alternatively, you can scan the QR to view all of the details of this property online.



arden
ESTATE AGENTS